

Le Ponant

It is with this ship that the PONANT adventure began more than 30 years ago. In its new livery, *Le Ponant* reinvents the cruise by going with the flow: authentic, intimate and hedonistic. Whether you're passionate about sailing or a fan of *la dolce vita*, you will enjoy the pleasure of a seamless reconnection with the elements, against a backdrop of magnificent scenery.



Length: 88 m
Width: 12 m
Draft: 4 m
Number of masts: 3
Total sail area: 1212 m² + 1000 m² spinnaker

Number of staterooms and suites: 16
Crew members: 33
Hybrid propulsion: sails, electric batteries, diesel engines
Year of delivery: 1991, renovated in 2021





Our historic yacht

It's through it that the **PONANT adventure began** more than 30 years ago. It's through it that a new era in sailing-ship cruising is beginning in 2022. Completely refurbished to combine the comfort of an exclusive luxury cruise with the pleasure of yachting. Authentic, intimately sized and dedicated to pleasure: in its new livery, **Le Ponant is redefining the very concept of cruising** along on the water in style. Enjoy the added luxury of more spacious cabins and share moments of complicit delight with a highly attentive crew on hand to see to your every

need. Whether you are passionate about sailing or simply a lover of the *dolce vita*, you will get to experience the pleasure of harmoniously reconnecting with the elements amidst spectacular scenery. Prepare to be surprised by a range of fine gastronomy and a wide variety of water-based leisure activities. **Through its hybrid propulsion system**, *Le Ponant* guarantees unique moments of navigation conducted in harmony with the regions traversed and with complete respect for the ecosystems that inhabit them.

Amenities

- Individual air-conditioning
- Double bed (180 cm x 200 cm) or two single beds (90 cm x 200 cm), depending on the cabin; adjoining cabins possible (child-friendly cruises)
- Minibar
- Flat-screen TV with satellite channels
- Bose™ bluetooth speaker
- Desk with writing paper
- Electronic safe
- Selection of Hermès® bath products
- Dressing table and hairdryer
- Direct phone line by satellite
- 110/220 volt electricity supply
- 24-hour room service
- Unlimited free Wi-Fi

Public areas

RECEPTION

LOUNGES

- **Emeraude bar and lounge:** library, tearoom, bar, and live entertainment on certain evenings. Access to the outdoor terrace
- **The outdoor bar:** lounge area

RESTAURANT

- **Le Diamant:**
Seating capacity: 34. Panoramic restaurant serving breakfast, lunch (buffet) and dinner (gastronomic menu). Refined organic cuisine made with local ingredients, and a range of fine food and drink products

LEASURES

- **The wellness space:**
Spa: massage cabin and Biologique Recherche care products. Fitness centre with dedicated fitness coach
Yoga sessions
- **Seawater pool**
- **Kayaks plus stand-up paddleboards**
- **Snorkelling and fishing equipment**
- **Diving equipment** (for a group of four people)
- Equipment for children (noodles, rings, armbands and safety equipment)
- Bicycles

Deck plans

Le Ponant

SUN DECK / Sun deck - Bar

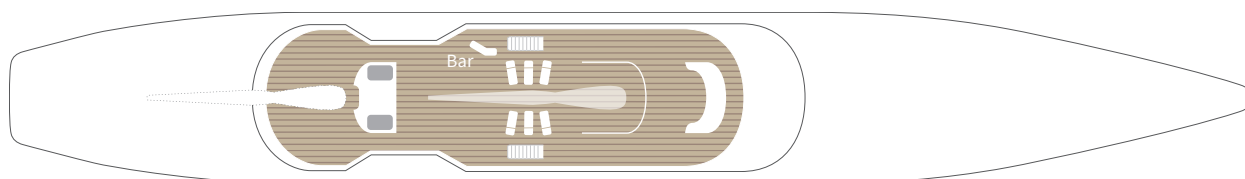

ZÉPHYR DECK / Panoramic restaurant *Le Diamant* - Bridge - Owner Suite

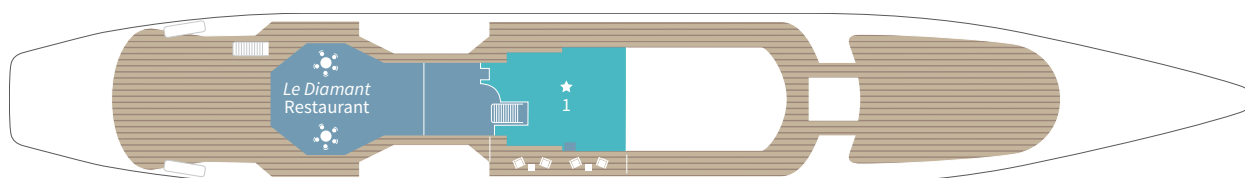

ALIZÉS DECK / Marina - Émeraude lounge - Reception - Welcome lounge - Beauty area - Fitness - Balcony suite - Balcony staterooms

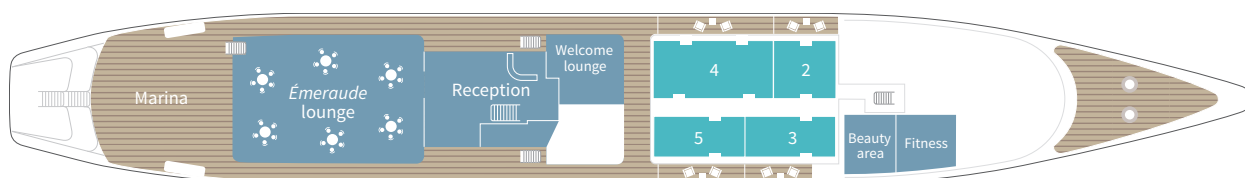

MISTRAL DECK / Infirmary - Porthole suites - Porthole staterooms

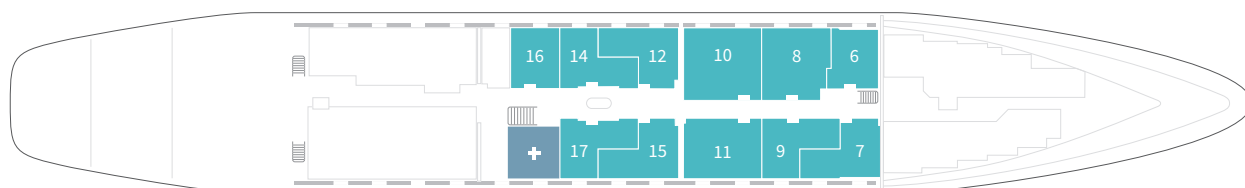

- 1 : Owner Suite
- 2 : Alizés Stateroom
- 3 and 5 : Alizés Prestige Staterooms
- 4 : Alizés Privilege Suite
- 6 and 16 : Mistral Staterooms
- 7, 9, 12, 14, 15 and 17 : Mistral Prestige Staterooms
- 8 and 11 : Mistral Junior Suites
- 10 : Mistral Prestige Suite

Discover your Stateroom

OWNER'S SUITE

(47 sq.m/506 sq.ft + 9 sq.m/97 sq.ft private balcony)

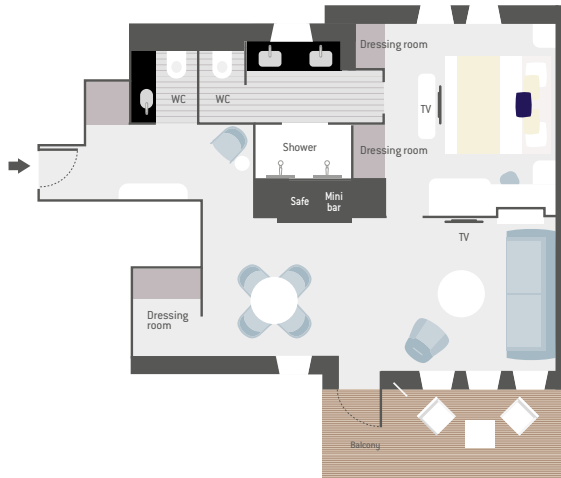

PRESTIGE MISTRAL SUITE

(27 sq.m/291 sq.ft + porthole)



JUNIOR MISTRAL SUITE

(22 sq.m/237 sq.ft + porthole)

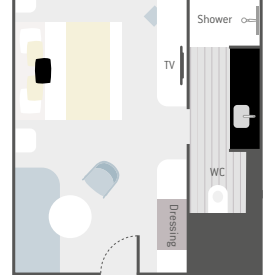

PRESTIGE MISTRAL STATEROOM

(16 sq.m/172 sq.ft + porthole)

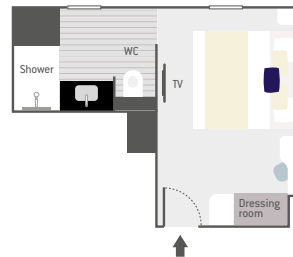

MISTRAL STATEROOM

(14 sq.m/151 sq.ft + porthole)



ALIZES GRAND PRIVILEGE SUITE

(49 sq.m/527 sq.ft + 13 sq.m/140 sq.ft private balcony)

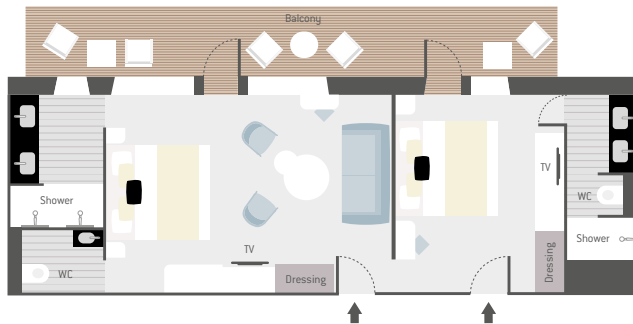

ALIZES PRIVILEGE SUITE

(30 sq.m/323 sq.ft + 9 sq.m/97 sq.ft private balcony)

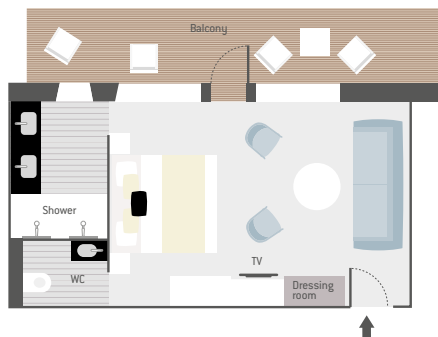

ALIZES STATEROOM

(19 sq.m/205 sq.ft + 4 sq.m/43 sq.ft private balcony)

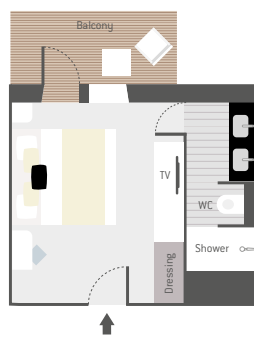

ALIZES PRESTIGE STATEROOM

(16 sq.m/172 sq.ft + 8 sq.m/86 sq.ft private balcony)

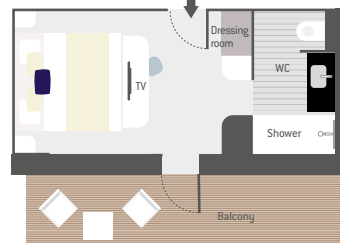

Discover *Le Ponant*
deck plans
by scanning
this QR code

